

Cross section to base C channel

Longitudinal section to base C channel

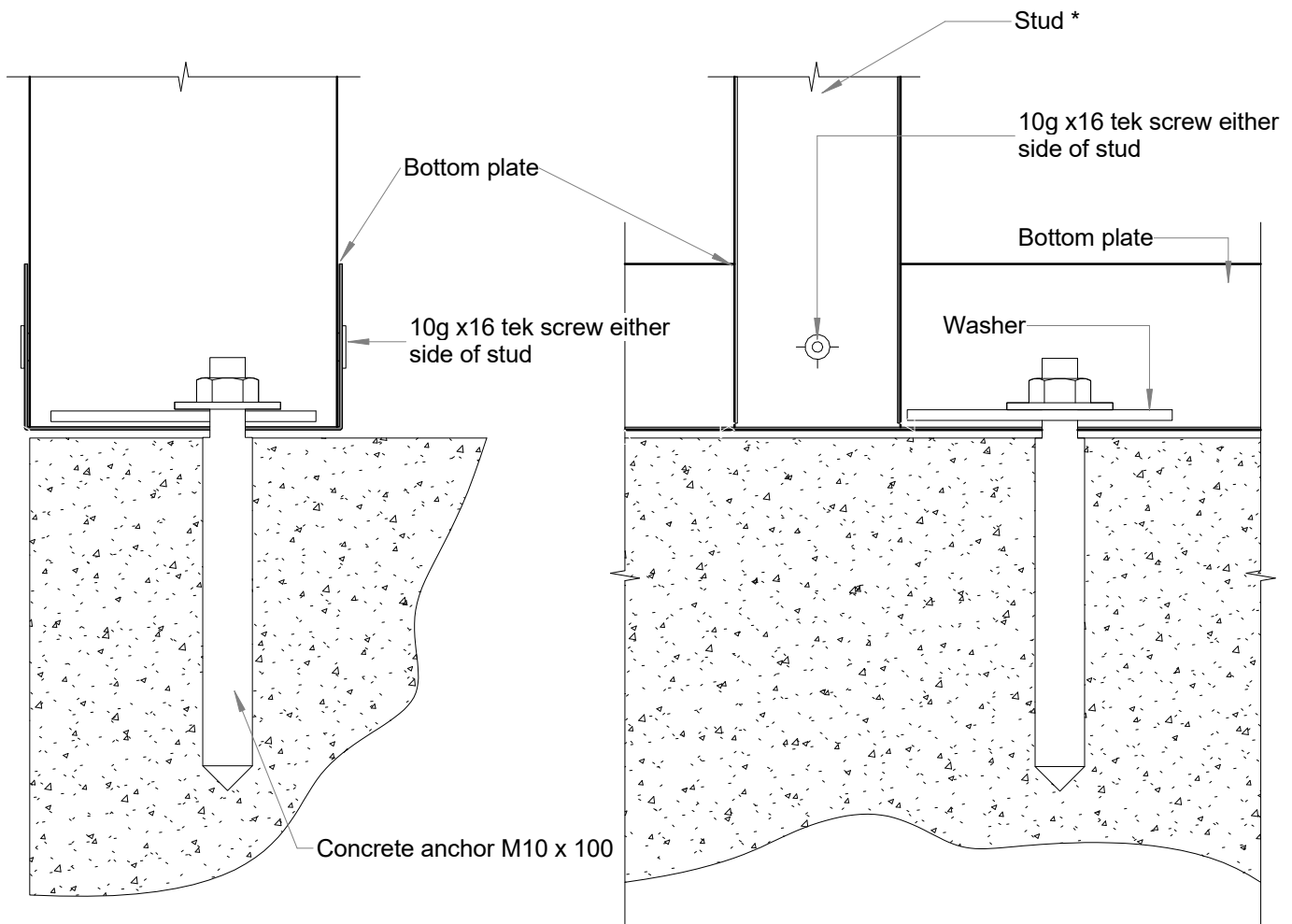

Top view to base C channel

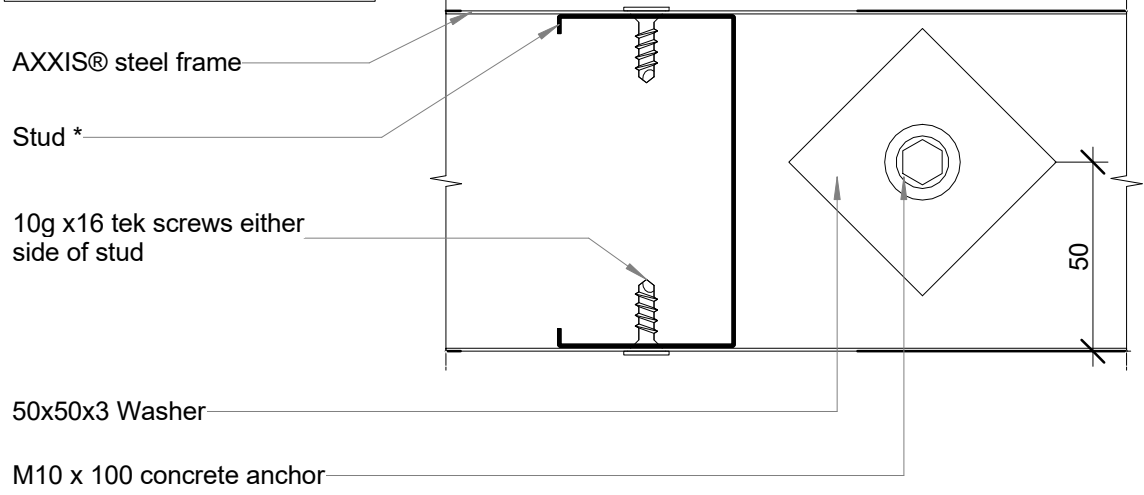

* Minimum 0.75mm framing material

**Typical 6kN Connection
(hold down within 150mm of stud)**

File: nzst_axxis_a1053 - flr-slb-6kn	Reference:
Scale: 1 : 2	A1053
Date: 14/03/16	